

This drawing and any data contained therein is the property of Gilbert Engineering Co., Inc. and, reproduction, use, alteration, modification, or distribution without the written consent of Gilbert Engineering Co., Inc. is prohibited. All rights are reserved. Use or reuse of this drawing without the written consent of Gilbert Engineering Co., Inc. is prohibited.

DWG. SS-7356-1 PART B

MATERIAL & FINISH

SHROUD: CRES 303 PER ASTM A484 &
ASTM 582, PASSIVATE PER
MIL F-14072 E 300

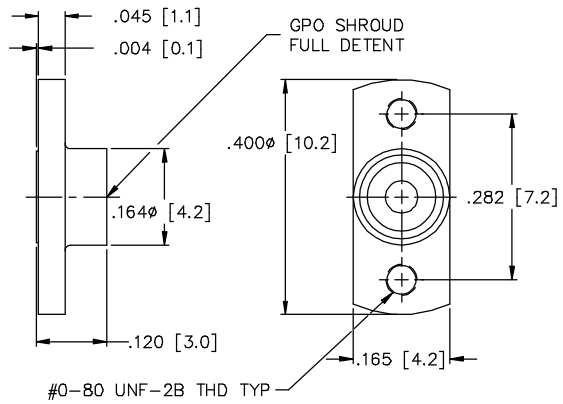

ALL DIMENSIONS ARE IN INCHES AND [MILLIMETERS]		CAT NO. 0119-605-3	CODE IDENT NO. 82316
GILBERT ENGINEERING CO., INC.			
BY	DATE	TITLE	
REL	8/11/93	GPO SHROUD FULL DETENT	
CHECKED		DWG. NO. SS-7356-1	REV B
	SHT. 1 OF 1		

85-1